

Scale 1" = 50'

708

707

706

FIRE HYDRANT WATER VALVES

SANITARY SVR. M.H.

H STREET (80' R.O.W.)
VOL. 83, PG. 344 H.C.D.R.

STORM SVR. M.H.

SET 5/8" IR V/CAP

N 87°07'44" E 396.87'

FND 1/2" IR

LA PORTE
OUTLOTS SUBDIVISION
VOLUME 83, PAGE 344, H.C.D.R.

W.M. JONES & SONS SURVEY

N 87°08'19" E 404.63'

CALLED 0.401 ACRES
GRANTON GLENN TOLAR, TRUSTEE
GRANTEE, CITY OF LA PORTE
H.C.C.F. NO. X218373
DATED 11/24/2003

711

712

713

FIRE HYDRANT WATER VALVE

CANADA ROAD
100' R.O.W.

8.2443 ACRES
359,122 Sq. Ft.

R.O.W. ALIQUOT FOR CANADA ROAD
AS APPROVED FOR CONSTRUCTION
FNI JOB NO. 01-1525 SHEET 2 OF 73

S 84°27'32" W 25.31'

6' C/L FNC. CDR.

N 03°22'37" W 25.00'

CALLLED 0.401 ACRES
GRANTON GLENN TOLAR, TRUSTEE
GRANTEE, CITY OF LA PORTE
H.C.C.F. NO. X218373
DATED 11/24/2003

6' C/L FNC. CDR.

N 84°27'32" E 25.31'

CALLLED 0.401 ACRES
GRANTON GLENN TOLAR, TRUSTEE
GRANTEE, CITY OF LA PORTE
H.C.C.F. NO. X218373
DATED 11/24/2003

INLET
GRATE TOP INLET

N 03°22'37" W 25.00'

INLET

INLET

INLET

INLET

INLET

INLET

INLET

INLET

INLET

INLET

INLET

INLET

INLET

INLET

INLET

INLET

INLET

INLET

INLET

INLET

INLET

INLET

INLET

INLET

INLET

INLET

INLET

INLET

INLET

INLET

INLET

INLET

INLET

INLET

INLET

INLET

INLET

PLACE OF BEGINNING
TEXAS STATE PLANE COORDINATE
SYSTEM - NAD83 - SOUTH
CENTRAL ZONE (4204)
N 12896650.71 - E 3208056.02

BLENDOUT

SET 5/8" IR V/CAP

S 86°54'37" W 404.26'

FND 1" IP

S 86°54'37" W 393.16'

FND 1/2" IR

FND 5/8" IR W/WILSON SURV.
GROUP CAP

64" RCP

TRAFFIC LIGHT ELECT. BOX

STREET SIGN

ELECT. BOX

ELECT. BOX

FAIRMONT PARKWAY
(250' R.O.W.)

SURVEY OF 8.2443 ACRES OUT OF THE W.M. JONES SURVEY, ABSTRACT 482, HARRIS COUNTY, TEXAS

I HAVE EXAMINED THE FLOOD INSURANCE RATE MAP, COMMUNITY PANEL NO. 4820100940, DATED NOVEMBER 6, 1996, AND HAVE DETERMINED THAT THE TRACT HEREBY SURVEYED LIES WHOLLY WITHIN ZONE "X" OR AREAS DETERMINED TO BE OUTSIDE 500-YEAR FLOODPLAIN. AND I HAVE EXAMINED THE FLOOD INSURANCE RATE MAP PRELIMINARY COMMUNITY PANEL NO. 4820100940, DATED SEPTEMBER 30, 2004 AND HAVE DETERMINED THAT THE TRACT HEREBY SURVEYED LIES WHOLLY WITHIN SHADDED ZONE "X" OR AREAS OF 0.2 2 ANNUAL CHANCE FLOOD AREAS OF 1% ANNUAL CHANCE FLOOD WITH AVERAGE DEPTHS OF LESS THAN 1 FOOT OR WITH DRAINAGE AREAS LESS THAN 1 SQUARE MILE AND AREAS PROTECTED BY LEVEES FROM 1% ANNUAL CHANCE FLOOD.
WARNING: THIS STATEMENT IS BASED ON SCALING THE LOCATION OF SAID SURVEY ON THE ABOVE REFERENCE MAP. THIS INFORMATION IS TO BE USED TO DETERMINE FLOOD INSURANCE RATES ONLY, AND IS NOT INTENDED TO IDENTIFY SPECIFIC FLOOD CONDITIONS.

NOTES:
1. SUBJECT TO THE ZONING AND/OR BUILDING ORDINANCES NOW IN FORCE IN THE CITY OF LA PORTE, TEXAS.
2. TITLE COMMITMENT FURNISHED BY CHICAGO TITLE COMPANY, C.F. NO. 00042433 44-901-80, ISSUED 02/24/2006.
3. SUBJECT TO AN UNLOCATED PIPELINE EASEMENT, GRANTED TO HUMBLE PIPELINE CO. BY INSTRUMENT RECORDED IN VOLUME 1178, PAGE 485, VOLUME 2352, PAGE 55 AND VOLUME 2982, PAGE 545, ALL OF THE DEED RECORDS OF HARRIS COUNTY, TEXAS.
4. BEARINGS BASED ON TEXAS STATE PLANE COORDINATE SYSTEM, SOUTH CENTRAL ZONE - NAD83, COMBINED SCALE FACTOR = 0.99981499.
5. PREPARED IN CONJUNCTION WITH DESCRIPTION DATED 03/14/2006.

I, SCOT LOWE, DO HEREBY CERTIFY THIS PLAT CORRECTLY REPRESENTS A BOUNDARY SURVEY MADE UNDER MY SUPERVISION ON THE GROUND, IN ACCORDANCE WITH THE INFORMATION PROVIDED ME AND CORRECTLY REPRESENTS THE FACTS AS FOUND AT THE TIME OF THIS SURVEY. THERE ARE NO ENCROACHMENTS EXCEPT AS SHOWN HEREON.

WITNESS MY HAND AND SEAL THIS THE 14th DAY OF MARCH, 2006.

SCOT LOWE
REGISTERED PROFESSIONAL LAND SURVEYOR NO. 5007

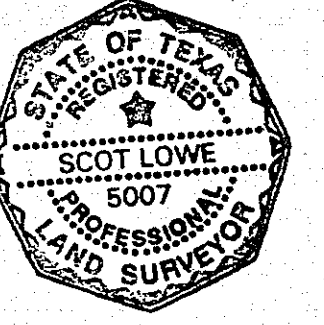

Land Surveying, Inc.
7438 Evie
Deer Park TX 77536

Phone: (281) 930-0201
Fax: (281) 930-0220

DRAWN BY: SAL/MBK	APPROVED BY: SAL
DATE: 3/14/2006	PROJ. NO. 06006
FIELD BK. #: 15147 P78	DWG. Z:\DWG\06006\06006.DWG
	REF. 05004, 05022